

Doe Li™ Lamp

Part # DOE LI LAMP

13-0619

PARTS

Plastic Nut

Note: All wires are connected. Take care when unpacking the packaging so the wires don't get damaged

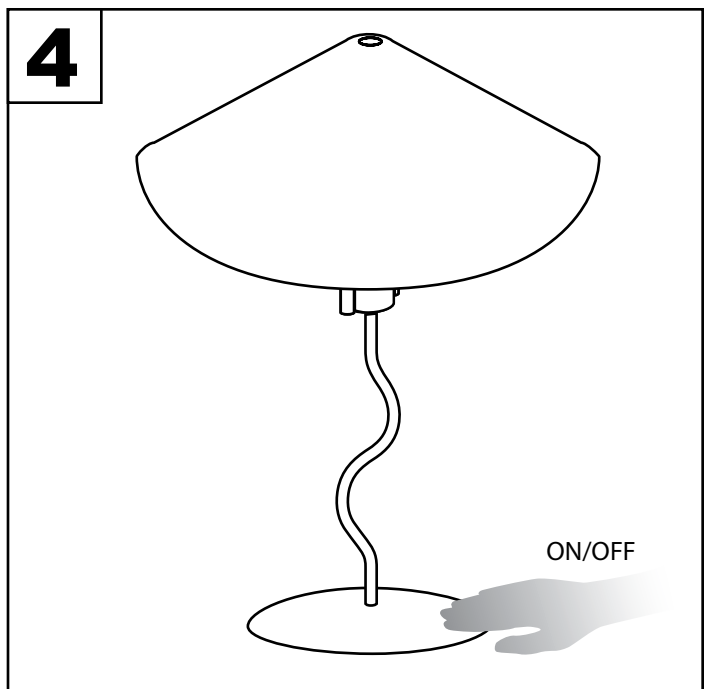
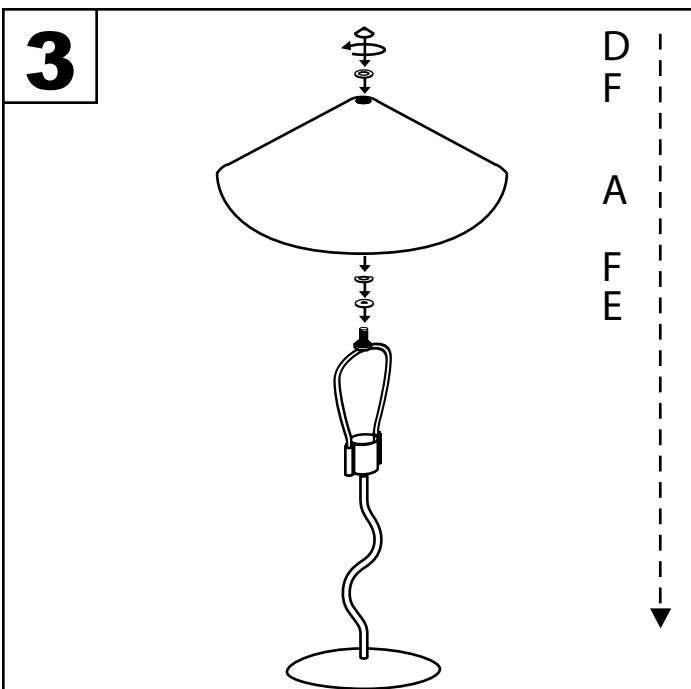
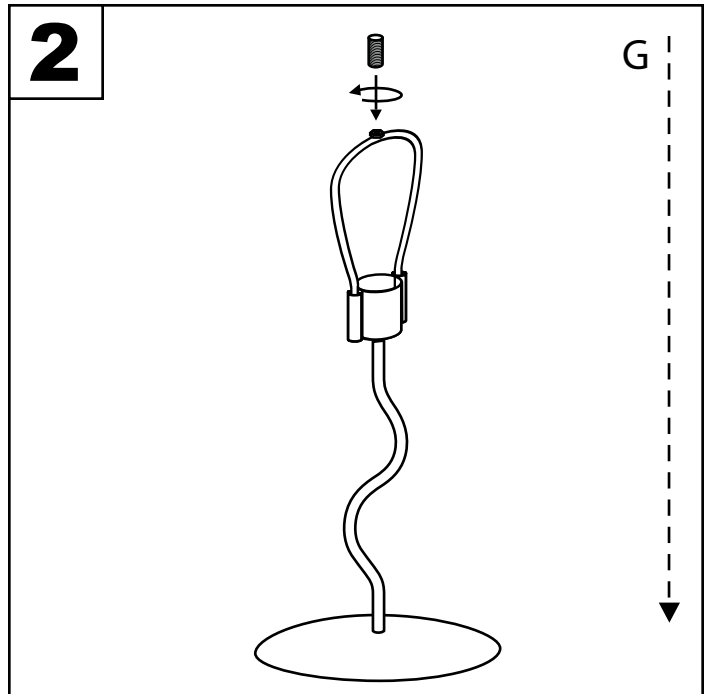
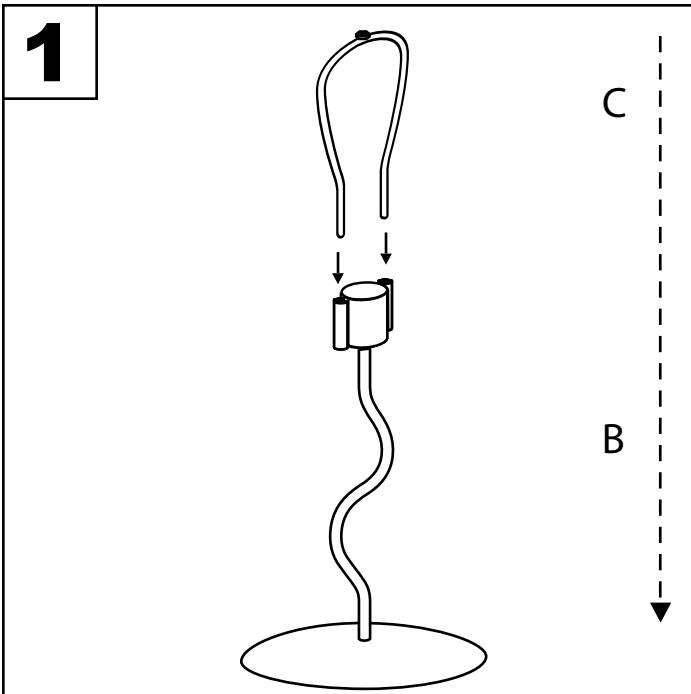

For indoor use only. Keep out of reach of children and animals. Place on flat surface and away from flammable materials. Never operate this appliance if it has a damaged cord, plug or cable. Keep cord away from heated and/or damp areas.

Use 120V~60Hz, 40 watt max.(or LED equivalent) type A E26 bulb only.